



# Application for Planning Approval

## ***Land Use Planning and Approvals Act 1993***

---

APPLICATION NO.

DA2022/189

LOCATION OF AFFECTED AREA

42 CROOKED BILLET DRIVE, BRIDGEWATER

DESCRIPTION OF DEVELOPMENT PROPOSAL

SIGNAGE (RETROSPECTIVE)

A COPY OF THE DEVELOPMENT APPLICATION MAY BE VIEWED AT [www.brighton.tas.gov.au](http://www.brighton.tas.gov.au) AND AT THE COUNCIL OFFICES, 1 TIVOLI ROAD, OLD BEACH, BETWEEN 8:15 A.M. AND 4:45 P.M., MONDAY TO FRIDAY OR VIA THE QR CODE BELOW. ANY PERSON MAY MAKE WRITTEN REPRESENTATIONS CONCERNING AN APPLICATION UNTIL 4:45 P.M. ON **21/9/2022**. ADDRESSED TO THE GENERAL MANAGER AT 1 TIVOLI ROAD, OLD BEACH, 7017 OR BY EMAIL AT [development@brighton.tas.gov.au](mailto:development@brighton.tas.gov.au). REPRESENTATIONS SHOULD INCLUDE A DAYTIME TELEPHONE NUMBER TO ALLOW COUNCIL OFFICERS TO DISCUSS, IF NECESSARY, ANY MATTERS RAISED.

**JAMES DRYBURGH**  
**General Manager**



**Brighton**  
going places

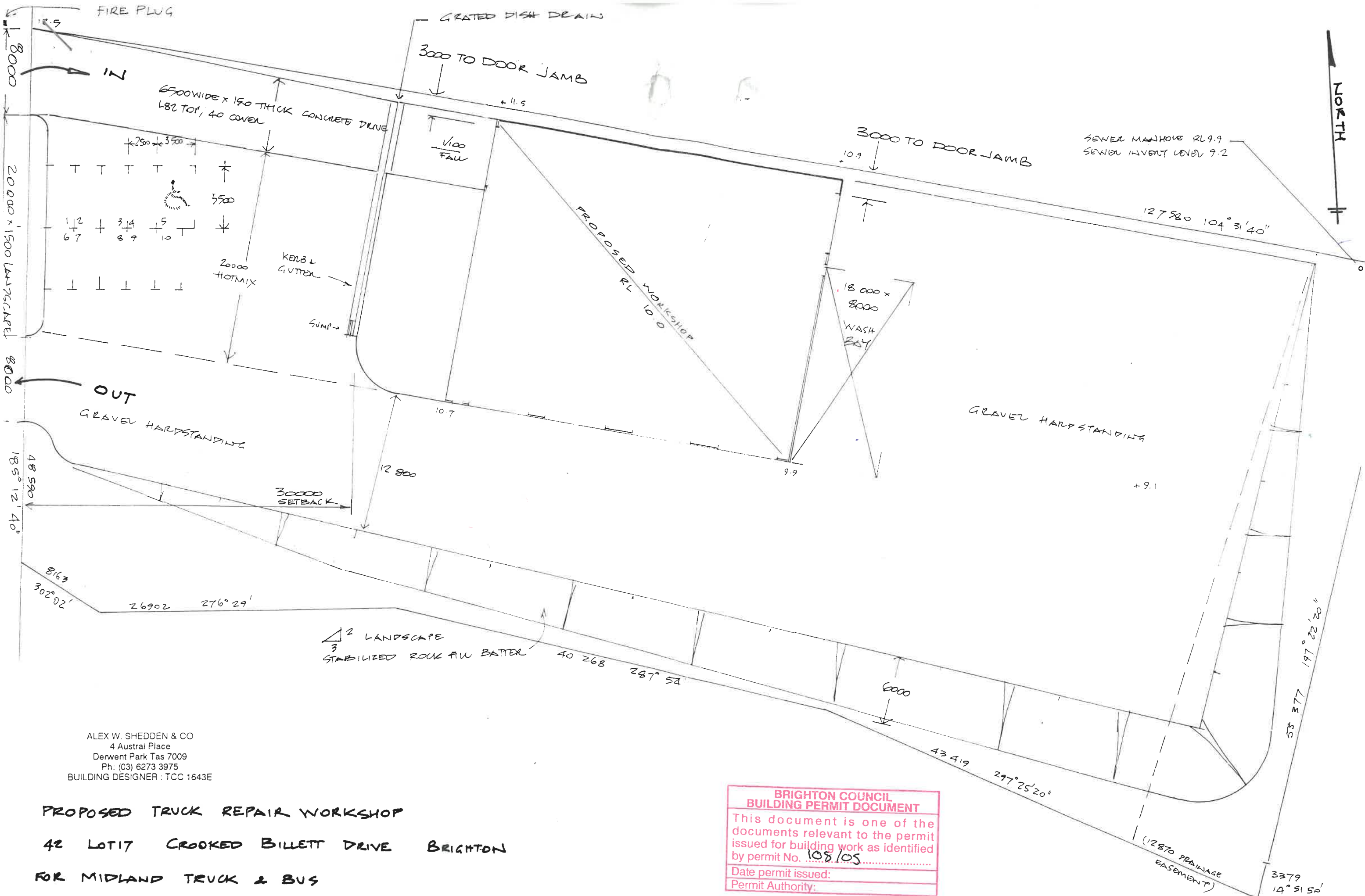

ALEX W. SHEDDEN & CO  
 4 Austral Place  
 Derwent Park Tas 7009  
 Ph: (03) 6273 3975  
 BUILDING DESIGNER : TCC 1643E

**PROPOSED TRUCK REPAIR WORKSHOP**  
 42 LOT17 CROOKED BILLET DRIVE BRIGHTON  
 FOR MIDLAND TRUCK & BUS  
 BY INDUSTRIAL ENGINEERING (TAS) P/L ph 0409 158 515  
 1:300 SCALE SITE PLAN 11/4/05 DRAWING No 5044/1

**BRIGHTON COUNCIL  
 BUILDING PERMIT DOCUMENT**  
 This document is one of the documents relevant to the permit issued for building work as identified by permit No. 108/05  
 Date permit issued:  
 Permit Authority:

*Mohd Yaly 26/4/05*



# MIDLAND TRUCK AND BUS

PH: (03) 6263 4333 FAX: (03) 6263 4555

42 CROOKED BILLET DRIVE BRIDGEWATER TAS 7030  
PO BOX 130 BRIDGEWATER TAS 7030



42 CROOKED BILLET DRIVE

ERECTION OF 6 (SIX) SIGNS ON BUILDING AND ENTRANCE FENCE

1200MM X 1200MM WHITE COLORBOND "TRADING HOURS" SIGN ON WEST FENCE

1000MM X 2400MM WHITE COLORBOND "TRADING HOURS" SIGN ON SOUTH WALL

1100MM X 1800MM "WESTERN STAR TRUCKS" SIGN ON WEST WALL

1100MM X 1550MM "MAN TRUCKS" SIGN ON WEST WALL

1200MM X 1200MM "CAT TRUCK ENGINES" SIGN ON WEST WALL

700MM X 1100MM "MIDLAND TRUCK AND BUS" SIGN ON WEST WALL



# MIDLAND TRUCK AND BUS



## TRADING HOURS

Mon - Fri 8.00am - 5.00pm  
Sat closed  
Sun Closed

Business Hours (03) 6283 4333  
After Hours 0408 138 774

