



Application for Planning Approval

Land Use Planning and Approvals Act 1993

APPLICATION NO.

DA 2019 / 00152

LOCATION OF AFFECTED AREA

23 ANDREW STREET, BRIGHTON

DESCRIPTION OF DEVELOPMENT PROPOSAL

OUTBUILDING

THE APPLICATION MAY BE VIEWED AT www.brighton.tas.gov.au AND AT THE COUNCIL OFFICES, 1 TIVOLI ROAD, OLD BEACH, BETWEEN 8:15 A.M. AND 4:45 P.M., MONDAY TO FRIDAY. ANY PERSON MAY MAKE WRITTEN REPRESENTATIONS CONCERNING AN APPLICATION UNTIL 4:45 P.M. ON **26/08/2019**. ADDRESSED TO THE GENERAL MANAGER AT 1 TIVOLI ROAD, OLD BEACH, 7017 OR BY EMAIL AT development@brighton.tas.gov.au. REPRESENTATIONS SHOULD INCLUDE A DAYTIME TELEPHONE NUMBER TO ALLOW COUNCIL OFFICERS TO DISCUSS, IF NECESSARY, ANY MATTERS RAISED.

RON SANDERSON
GENERAL MANAGER

Brighton
going places

EXIST GARDEN SHED

Proposed 6x6m Shed
Not to Scale.

WS 1

EXIST STRAWBERRY GARDEN

EXIST GATE

EXIST FENCE

EXIST SWING

333/93

2.3.94

CH. SP

EXIST LAWN

EXIST DEVELOPED FRUIT TREES

EXIST GARDEN BED SHAUBS FLOWERS & WOODCHIP

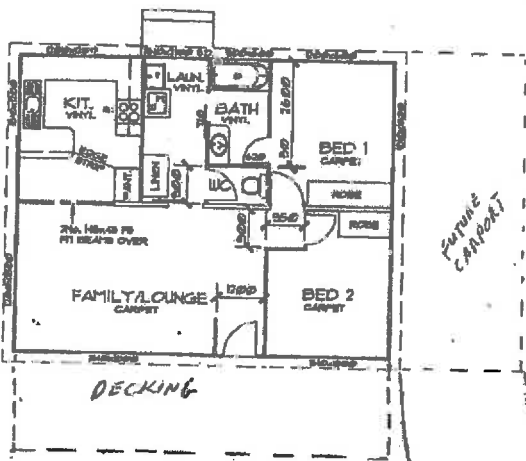

EXIST LAWN

EXIST SHAUB

EXIST LAWN

ASPHALT DRIVE WAY

EXIST GARDEN BED SHAUBS & WOODCHIP

EXIST TUMBLER FENCE ON METAL POST

31

(5)

8

15

9' 58' 00"

45' 04"

60.5

13m²

00

ANDREW ST A

ABSCO DOUBLE ROLLER DOOR GARAGE:

THIS PRODUCT HAS A WIND RATING OF: W41-N3 (NON-CYCLONIC REGIONS)

IT IS NOT SUITABLE FOR CONSTRUCTION IN CYCLONIC REGIONS C1, C2 or C3

G663325R2

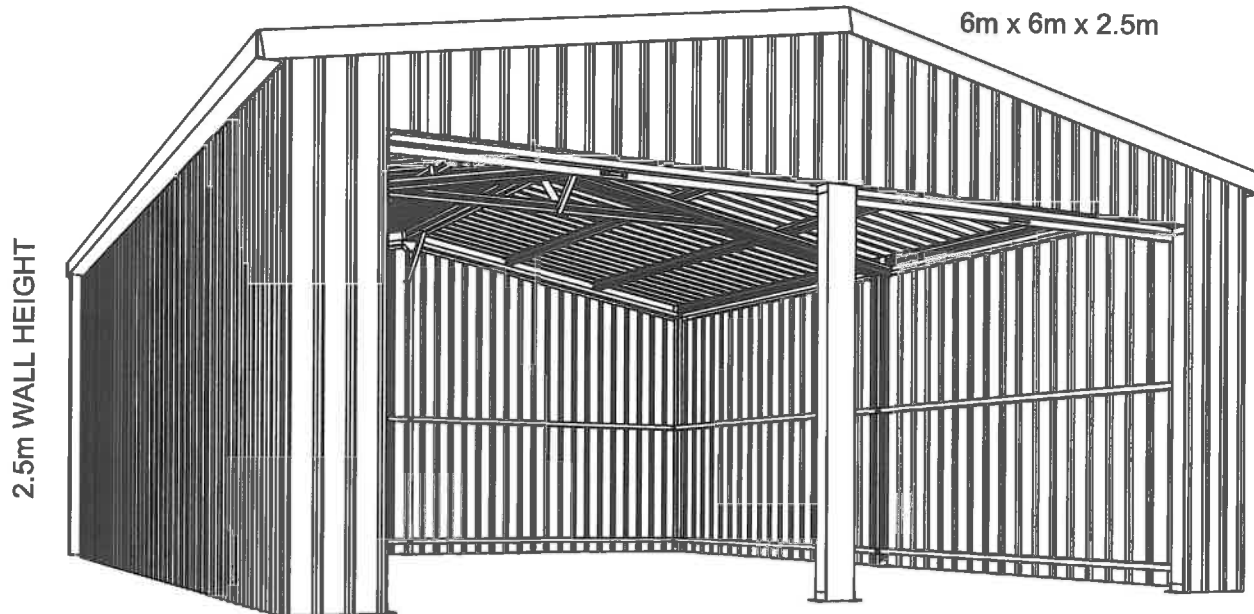

DOOR CLEARANCE:
WIDTH=2400 mm
HEIGHT=2100mm

GENERAL INSTRUCTIONS:

LOCAL AUTHORITY APPROVAL MUST BE OBTAINED PRIOR TO CONSTRUCTION. ONCE YOU HAVE SELECTED YOUR SITE, DRAW A SITE PLAN AND LODGE YOUR APPLICATION TOGETHER WITH A COPY OF THE ENGINEERING PLANS LOCATED AT THE BACK OF THESE INSTRUCTIONS.

READ THESE INSTRUCTIONS CAREFULLY AND FULLY SO THAT AN UNDERSTANDING OF THE STEPS INVOLVED IN CONSTRUCTION IS OBTAINED. DO THIS WITH CONSTANT REFERENCE TO THE ENGINEERING DRAWINGS PROVIDED.

MEASURE AND CHECK OFF ALL THE COMPONENTS PRIOR TO COMMENCEMENT. IF A DISCREPANCY IS DISCOVERED, CONTACT ABSCO INDUSTRIES IMMEDIATELY FOR ASSISTANCE.

INTERNAL FRAMING:

THE INTERNAL FRAMING OF THE GARAGE IS CONSTRUCTED FROM 80mm x 40mm GALVANISED STEEL CHANNEL SECTION, SIMILAR TO SECTIONS USED IN DOMESTIC STEEL HOUSE FRAMING.

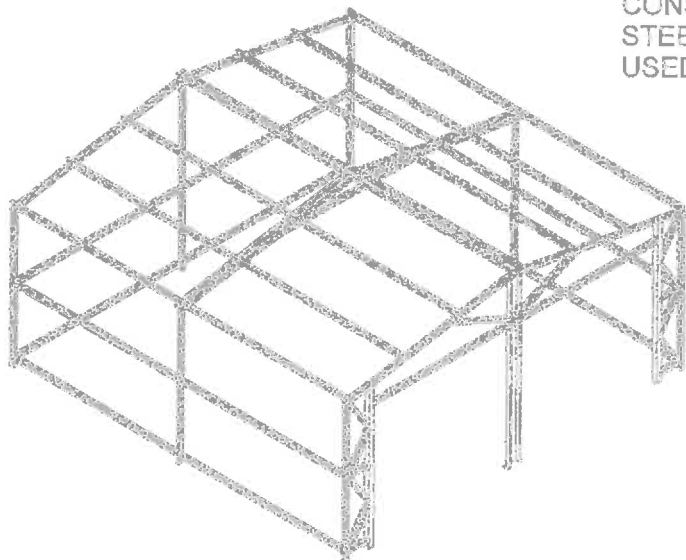

MOST OF THESE CHANNEL SECTIONS HAVE BEEN BRANDED WITH PART NUMBERS FOR EASY IDENTIFICATION, AND PACKED IN SEPERATE BUNDLES FOR EACH FRAME TYPE. (REFER TO THE PARTS LIST ON PAGE 3)

IT IS NOT NECESSARY TO PRE-CHECK THESE SECTIONS AS THEY ARE PRODUCED USING STATE OF THE ART ROLLFORMING EQUIPMENT. IT IS ADVISABLE TO ONLY OPEN EACH BUNDLE AS YOU BEGIN TO ASSEMBLE EACH INDIVIDUAL FRAME SECTION. BY DOING THIS, YOU WILL AVOID GETTING SIMILAR LENGTH SECTIONS WITH DIFFERENT NOTCHING PATTERNS MIXED TOGETHER.

CAUTION:

SOME ITEMS MAY HAVE SHARP EDGES AND IT IS ADVISABLE TO WEAR PROTECTIVE GLOVES WHEN HANDLING THEM. CARE MUST ALSO BE TAKEN TO AVOID EYE INJURY WHEN DRILLING HOLES. PLEASE WEAR SAFETY GLASSES.

REAR FRAME DIMENSIONS

NOTE:* HIGHLIGHTED DIMENSIONS IDENTICAL FOR REAR, CENTRE AND FRONT FRAMES.**

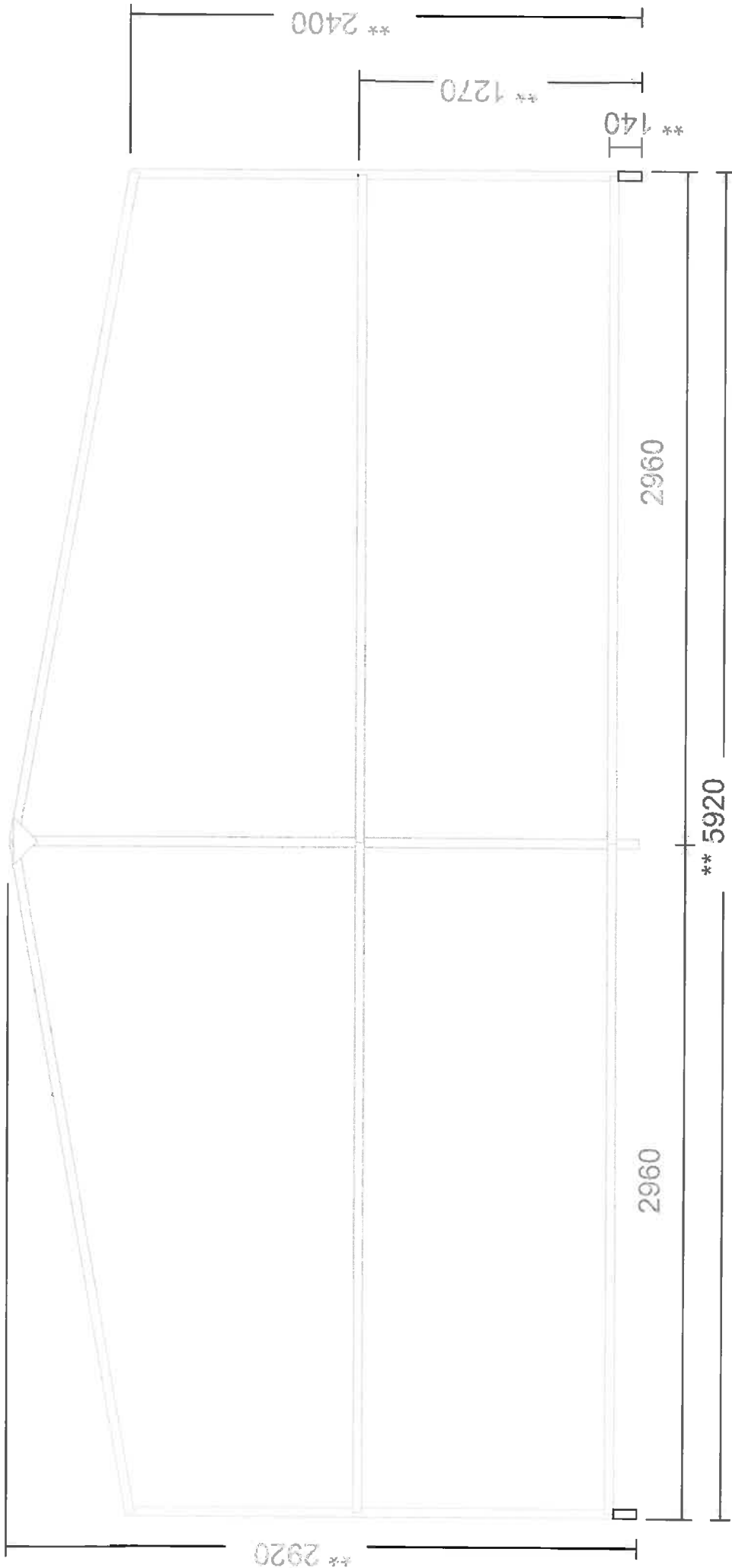

- LAY THE PARTS OUT ON YOUR SLAB OR LEVEL AREA AS SHOWN.
- CHECK DIAGONALS FOR SQUARENESS, THEN JOIN ALL COMPONENTS TOGETHER WITH SELF DRILLING SCREWS.
- RE-CHECK THE DIMENSIONS, THEN MARK AROUND THE OUTSIDE OF THE FRAME WITH CHALK SO THAT YOU HAVE A TEMPLATE FOR THE REMAINING FRAMES.
- USING THE 100mm BRACKET CONNECTORS, BOX THE BOTTOM OF THE TWO CORNER LEGS AS SHOWN ON THE PREVIOUS PAGE.
- CAREFULLY TURN THE FRAME OVER AND FASTEN WITH SCREWS ON THE OPPOSITE SIDE.